

# Initial Setup:

## Connect mySpreader App to AMAZONE Bluetooth Adapter

(only necessary if it has not been connected before)

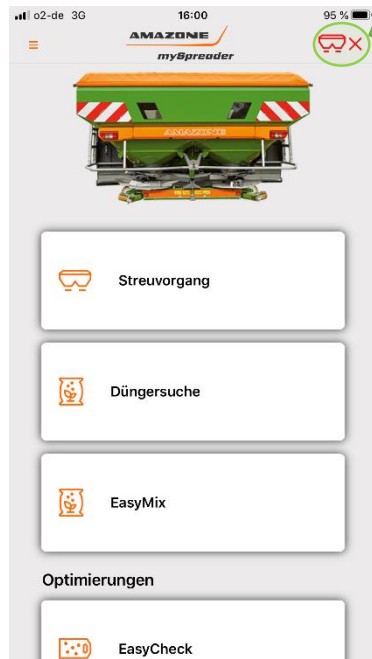

1. Connect to AMAZONE Bluetooth Adapter

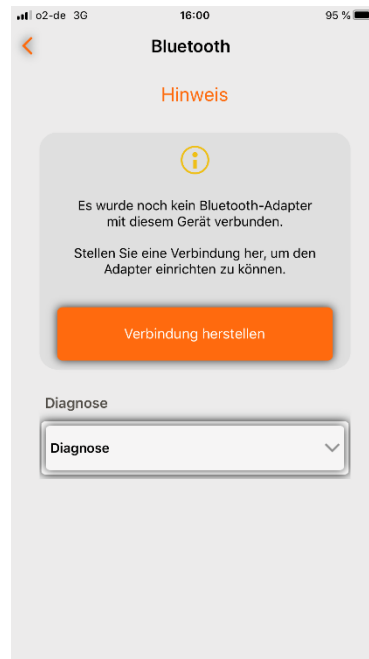

2. Search for AMAZONE Bluetooth Adapter

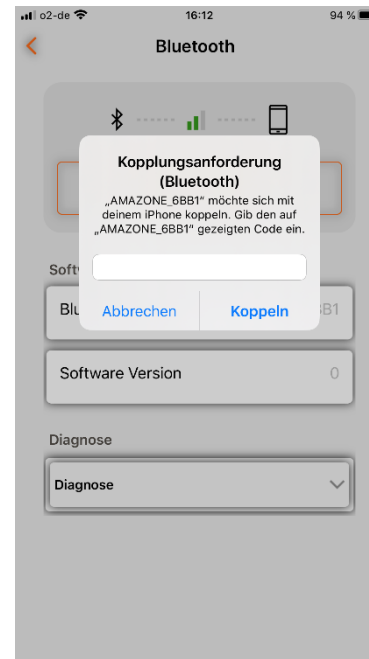

3. Enter PIN from Terminal

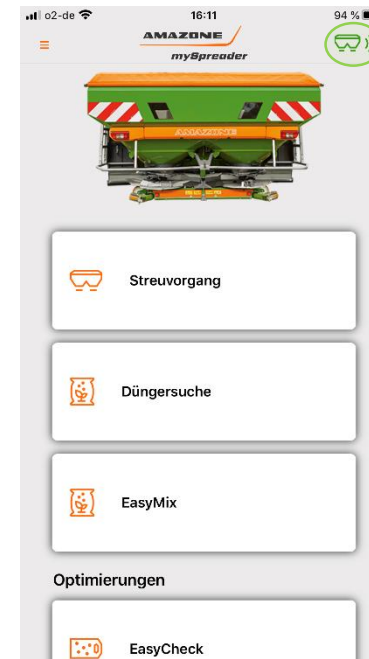

4. Connection Established

Note: Machine Software > NW188-C required!